

CITY OF DELAVAN WALWORTH COUNTY, WISCONSIN STREET MAP

--- CITY LIMITS

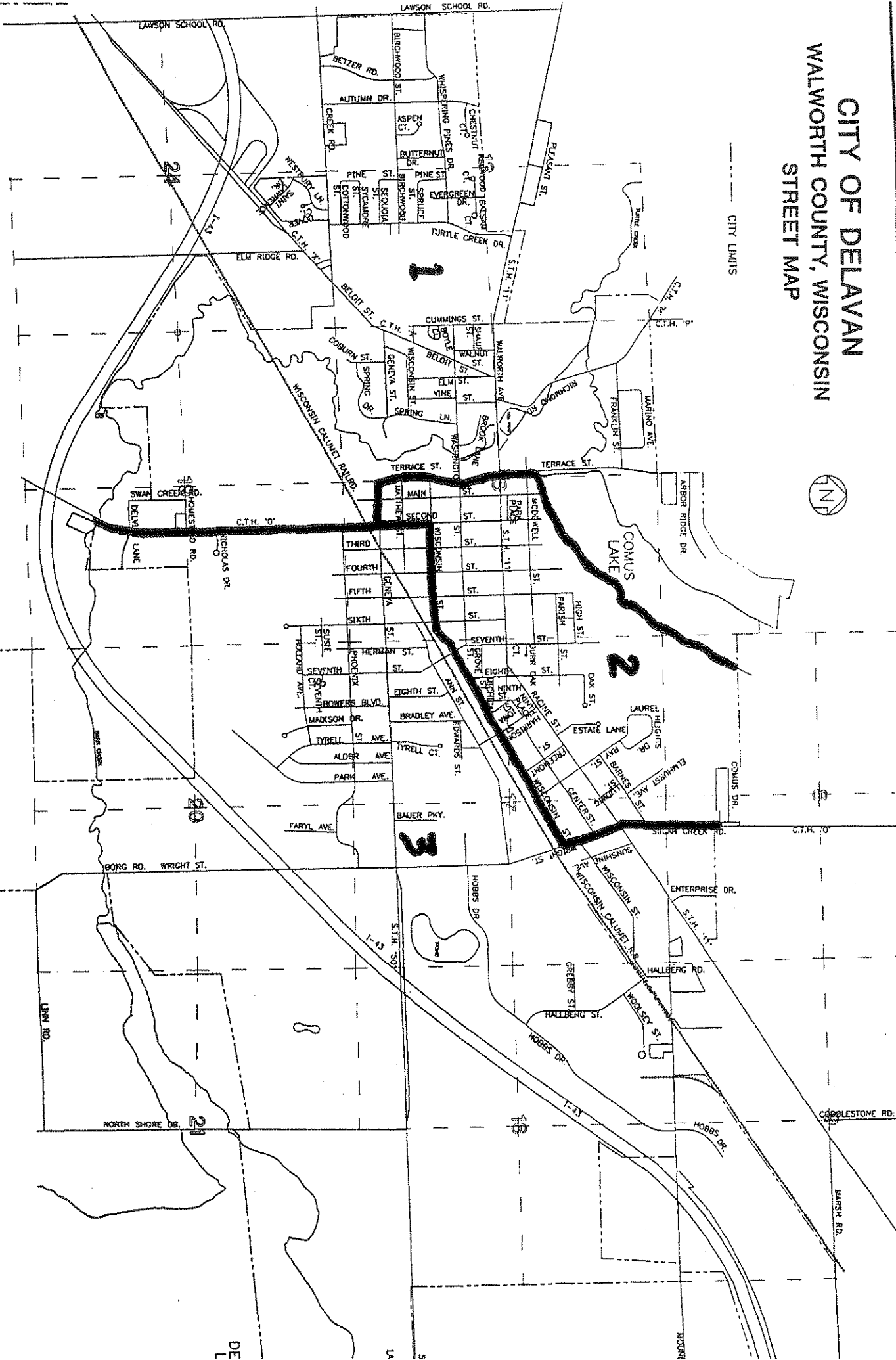

Barter & Woodman
 City of Delavan, Wisconsin 53115
 2000 North Shore Dr. Delavan, WI 53115
 Phone: 920.888.1111 Fax: 920.888.1112

OFFICIAL BALLOT FOR NONPARTISAN OFFICE

NOTICE TO ELECTORS: THIS BALLOT MAY BE INVALID UNLESS INITIALED BY 2 ELECTION INSPECTORS. IF CAST AS AN ABSENTEE BALLOT, THE BALLOT MUST BEAR THE INITIALS OF THE MUNICIPAL CLERK OR DEPUTY CLERK.

To vote for the candidate of your choice, completely darken the oval to the LEFT of the candidate's name like this . To vote for a person whose name does not appear on the ballot, write the person's name on the line provided and completely darken the oval to the LEFT of the person's name like this .

JUDICIAL	MUNICIPAL (cont.)
<p style="text-align: center;">Court of Appeals Judge, District 2 Vote for One</p> <p><input type="radio"/> Paul F. Reilly</p> <p><input type="radio"/> Linda M. Van De Water</p> <p><input type="radio"/> Write-in</p>	<p style="text-align: center;">Municipal Judge Vote for One</p> <p><input type="radio"/> James A Ritchie</p> <p><input type="radio"/> LeRoy H Himebauch</p> <p><input type="radio"/> Write-in</p>
<p style="text-align: center;">Circuit Court Judge, Branch 2 Vote for One</p> <p><input type="radio"/> James L. Carlson</p> <p><input type="radio"/> Write-in</p>	<p style="text-align: center;">SCHOOL DISTRICT</p>
<p style="text-align: center;">Circuit Court Judge, Branch 4 Vote for One</p> <p><input type="radio"/> David A. Danz</p> <p><input type="radio"/> David M. Reddy</p> <p><input type="radio"/> Write-in</p>	<p style="text-align: center;">Delavan-Darien School District School Board Member Town of Darien, Sugar Creek, Bradford & Richmond Vote for One</p> <p><input type="radio"/> Joey Scholle Torkelson</p> <p><input type="radio"/> Write-in</p>
COUNTY	
<p style="text-align: center;">County Supervisor, District 8 Vote for One</p> <p><input type="radio"/> Daniel G. Kilkenny</p> <p><input type="radio"/> Write-in</p>	<p style="text-align: center;">Delavan-Darien School District School Board Member Village of Darien, Town of Sharon & Town of Walworth Vote for One</p> <p><input type="radio"/> James M. Hansen</p> <p><input type="radio"/> Write-in</p>
MUNICIPAL	
<p style="text-align: center;">Mayor Vote for One</p> <p><input type="radio"/> Mel Nieuwenhuis</p> <p><input type="radio"/> Ron Siedelmann</p> <p><input type="radio"/> Write-in</p>	SAMPLE District 1
<p style="text-align: center;">Aldersperson, District 1 Vote for One</p> <p><input type="radio"/> Gary Stebnitz</p> <p><input type="radio"/> John K Finley</p> <p><input type="radio"/> Write-in</p>	

**OFFICIAL BALLOT
FOR NONPARTISAN OFFICE**

April 6, 2010

For
**CITY OF DELAVAN W1-3 ALD DIST
1
Walworth County, WI**

Ballot issued by _____

(initials of inspectors)

Absentee Ballot issued by _____
(initials of municipal clerk or deputy clerk)

Certification of Elector Assistance

I certify that the within ballot was marked by me for an elector who is authorized under the law to have assistance upon request and as directed by the elector.

(signature of assisting elector)

OFFICIAL BALLOT FOR NONPARTISAN OFFICE

NOTICE TO ELECTORS: THIS BALLOT MAY BE INVALID UNLESS INITIALED BY 2 ELECTION INSPECTORS. IF CAST AS AN ABSENTEE BALLOT, THE BALLOT MUST BEAR THE INITIALS OF THE MUNICIPAL CLERK OR DEPUTY CLERK.

To vote for the candidate of your choice, completely darken the oval to the LEFT of the candidate's name like this . To vote for a person whose name does not appear on the ballot, write the person's name on the line provided and completely darken the oval to the LEFT of the person's name like this .

JUDICIAL	MUNICIPAL (cont.)	
<p>Court of Appeals Judge, District 2 Vote for One</p> <p><input type="radio"/> Paul F. Reilly</p> <p><input type="radio"/> Linda M. Van De Water</p> <p><input type="radio"/> Write-in</p>	<p>Aldersperson, District 2 (1 Year Term) Vote for One</p> <p><input type="radio"/> David G Kilkenny</p> <p><input type="radio"/> Sam Riggs</p> <p><input type="radio"/> Write-in</p>	<p>OFFICIAL BALLOT FOR NONPARTISAN OFFICE</p> <p>April 6, 2010</p> <p>For CITY OF DELAVAN W4-6,10 ALD DIST II Walworth County, WI</p>
<p>Circuit Court Judge, Branch 2 Vote for One</p> <p><input type="radio"/> James L. Carlson</p> <p><input type="radio"/> Write-in</p>	<p>Municipal Judge Vote for One</p> <p><input type="radio"/> James A Ritchie</p> <p><input type="radio"/> LeRoy H Himebauch</p> <p><input type="radio"/> Write-in</p>	
<p>Circuit Court Judge, Branch 4 Vote for One</p> <p><input type="radio"/> David A. Danz</p> <p><input type="radio"/> David M. Reddy</p> <p><input type="radio"/> Write-in</p>	<p>SCHOOL DISTRICT</p> <p>Delavan-Darien School District School Board Member Town of Darien, Sugar Creek, Bradford & Richmond Vote for One</p> <p><input type="radio"/> Joey Scholle Torkelson</p> <p><input type="radio"/> Write-in</p>	
<p>COUNTY</p> <p>County Supervisor, District 8 Vote for One</p> <p><input type="radio"/> Daniel G. Kilkenny</p> <p><input type="radio"/> Write-in</p>	<p>Delavan-Darien School District School Board Member Village of Darien, Town of Sharon & Town of Walworth Vote for One</p> <p><input type="radio"/> James M. Hansen</p> <p><input type="radio"/> Write-in</p>	
<p>MUNICIPAL</p> <p>Mayor Vote for One</p> <p><input type="radio"/> Mel Nieuwenhuis</p> <p><input type="radio"/> Ron Siedelmann</p> <p><input type="radio"/> Write-in</p>	<p style="font-size: 2em; font-weight: bold; opacity: 0.5;">SAMPLE District 2</p>	
<p>Aldersperson, District 2 (2 Year Term) Vote for One</p> <p><input type="radio"/> Sam Riggs</p> <p><input type="radio"/> Wm Bruce DeWitt</p> <p><input type="radio"/> Write-in</p>	<p>Absentee Ballot issued by</p> <p>_____</p> <p>(initials of inspectors)</p> <hr/> <p>Certification of Elector Assistance</p> <p>I certify that the within ballot was marked by me for an elector who is authorized under the law to have assistance upon request and as directed by the elector.</p> <p>_____</p> <p>(signature of assisting elector)</p>	

OFFICIAL BALLOT FOR NONPARTISAN OFFICE

NOTICE TO ELECTORS: THIS BALLOT MAY BE INVALID UNLESS INITIALED BY 2 ELECTION INSPECTORS. IF CAST AS AN ABSENTEE BALLOT, THE BALLOT MUST BEAR THE INITIALS OF THE MUNICIPAL CLERK OR DEPUTY CLERK.

To vote for the candidate of your choice, completely darken the oval to the LEFT of the candidate's name like this . To vote for a person whose name does not appear on the ballot, write the person's name on the line provided and completely darken the oval to the LEFT of the person's name like this .

JUDICIAL	MUNICIPAL (cont.)	OFFICIAL BALLOT FOR NONPARTISAN OFFICE April 6, 2010 For CITY OF DELAVAN W7-9,11 ALD DIST III Walworth County, WI
Court of Appeals Judge, District 2 Vote for One <input type="radio"/> Paul F. Reilly <input type="radio"/> Linda M. Van De Water <input type="radio"/> Write-in	Municipal Judge Vote for One <input type="radio"/> James A Ritchie <input type="radio"/> LeRoy H Himebauch <input type="radio"/> Write-in	
Circuit Court Judge, Branch 2 Vote for One <input type="radio"/> James L. Carlson <input type="radio"/> Write-in	SCHOOL DISTRICT	
Circuit Court Judge, Branch 4 Vote for One <input type="radio"/> David A. Danz <input type="radio"/> David M. Reddy <input type="radio"/> Write-in	Delavan-Darien School District School Board Member Town of Darien, Sugar Creek, Bradford & Richmond Vote for One <input type="radio"/> Joey Scholle Torkelson <input type="radio"/> Write-in	
COUNTY	Delavan-Darien School District School Board Member Village of Darien, Town of Sharon & Town of Walworth Vote for One <input type="radio"/> James M. Hansen <input type="radio"/> Write-in	
County Supervisor, District 8 Vote for One <input type="radio"/> Daniel G. Kilkenny <input type="radio"/> Write-in		
MUNICIPAL	SAMPLE District 3	
Mayor Vote for One <input type="radio"/> Mel Nieuwenhuis <input type="radio"/> Ron Siedelmann <input type="radio"/> Write-in	Ballot issued by _____ (initials of inspectors)	
Alderpersn, District 3 Vote for One <input type="radio"/> Jeff Johnson <input type="radio"/> Shannon Markley <input type="radio"/> Write-in	Absentee Ballot issued by _____ (initials of municipal clerk or deputy clerk)	
	Certification of Elector Assistance I certify that the within ballot was marked by me for an elector who is authorized under the law to have assistance upon request and as directed by the elector. _____ (signature of assisting elector)	